

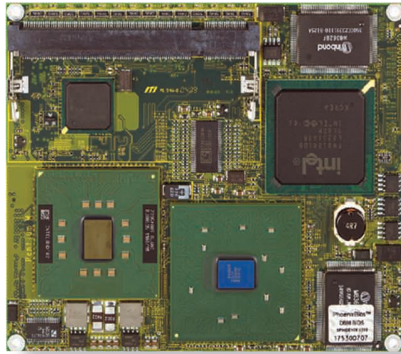

EmETX-i701

Intel® Celeron® M 600MHz/Pentium® M 1.1GHz ETX® CPU Module



ETX

Features

- Soldered Onboard Intel® Celeron® M 600MHz/Pentium® M 1.1GHz Processor
- Dual Channels 18-bit LVDS, and Analog RGB
- Dual Independent Displays
- Multi-expansion (4 x USB, 2 x PATA, 2 x Serial Ports, 4 x PCI Masters, ISA Bus)
- **Extended Operating Temp.: -20 ~ 70°C**

System

CPU	Soldered onboard Intel® ULV Celeron® M 600MHz/ Pentium® M 1.1GHz CPU with 400MHz FSB
Memory	1 x 200-pin DDR SO-DIMM Socket supporting 200/266MHz SDRAM up to 1GB
Chipset	Intel® 852GM + ICH4
BIOS	Phoenix-Award PnP Flash BIOS
Storage	2 x Ultra ATA, support 4 IDE devices 1 x Floppy disk drive shared with parallel port
Watchdog Timer	1~255 levels reset

I/O

I/O Chip	Winbond W83627HG
Serial Port	2 x COM ports (1 x RS-232, 1 x RS-232/422/485 selectable via PBE-1000)
Parallel Port	SPP/EPP/ECP mode
USB Port	4 x USB 2.0 ports
KB/MS	PS/2 interface for Keyboard and Mouse (via PBE-1000)
Expansion Bus	PCI (4 x PCI masters) and ISA bus

Ethernet

Chipset	1 x Intel® 82562EZ 10/100Base-T Ethernet controller
----------------	---

Audio

CODEC/Interface	Realtek ALC655 6 Channel AC97 Audio CODEC, Mic-in/ Line-in/Line-out
------------------------	---

Ordering Information

EmETX-i701/CM600	Intel® Celeron® M 600MHz ETX® CPU module
EmETX-i701/PM1100	Intel® Pentium® M 1.1GHz ETX® CPU module
HS-0701-C3	Heatsink with fan (116 x 96 x 37 mm)
HS-0701-F2	Heat spreader (114 x 95 x 8 mm)
PBE-1000 R2.1	ETX® evaluation board in ATX form factor Page 1-20
CBK-05-1000-00	Cable kit for PBE-1000 R2.1
	1 x FDD cable
	3 x COM port cables
	1 x USB cable
	2 x IDE cables
	1 x TV-out cable

Display

Graphics Chipset	Integrated Intel® 852GM Extreme Graphics2 Engine up to 64MB UMA Video RAM
Graphics Interface	Analog RGB support up to 2048 x 1536 LCD: Dual Channels 18-bit LVDS UXGA up to 1600 x 1200 Support dual independent displays

Mechanical & Environmental

Power Consumption	3.53A/5V with Intel® Celeron® M 600MHz 5.5A/5V Intel® Pentium® M 1.4GHz
Operating Temp.	-20 ~ 70°C (-4 ~ 158°F)
Operating Humidity	0 ~ 90% (non-condensing)
Dimension (L x W)	114 x 95 mm (4.5" x 3.7")

Dimensions

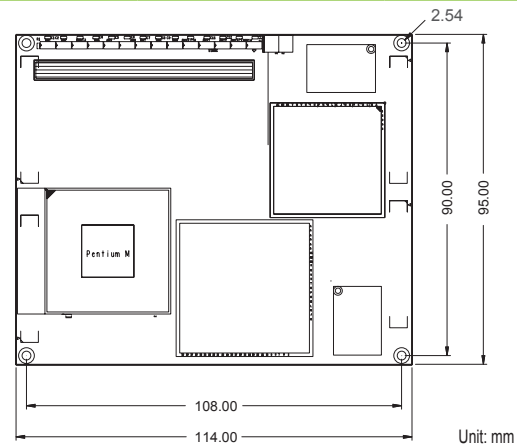

Ordering Information

PBE-1100-R R1.3	PBE-1100 R1.3 ETX® carrier board w/ Realtek 8100CL 10/100Base-T Ethernet controller, CF shared with IDE2 Page 1-21	
PBE-1100-I R1.3	PBE-1100 R1.3 ETX® carrier board w/ Intel® 82551QM 10/100Base-T Ethernet controller, CF shared with IDE2 Page 1-21	
CBK-10-1100-00	Cable kit for PBE-1100 R1.3	
	1 x Audio cable	2 x Ethernet cables
	2 x USB cables	1 x IDE cable
	2 x COM port cables	1 x VGA cable
	1 x LPT to FDD cable	1 x Power cable (4 wires)
	1 x LPT cable	1 x Power cable (2 wires)

All specifications are subject to change without notice.